



SMALL SIZE & POWERFUL PERFORMANCE

IMMUNIA-STAT

Fluorescence Immunoassay Analyzer



Immunia-Stat

Fluorescence Immunoassay Analyzer

Immunia-Stat

Dimensions: 200 * 90 * 52 mm(L*W*H)

Weight: 0.65Kg

Large Display

5-inch LCD Touch Screen

Intuitive and friendly UI

Connection

Direct connection to LIS/HIS

Test cassettes

Standard Mode

Random Mode

Emergency Mode



RFID

Dedicated Magnetic Card for each batch of reagents, swipe the magnetic card

Consumable

All test cassette and consumables include

Bar Code Reader

Automatically read batch code and calibration information

Type C Interface

Built-in battery

Stand by time up to 3 days

Flexible charging method

Multiple-sample types

support whole blood, serum, plasma, etc.

Reliable & Accuracy

Good correlation with CLIA method

Rapid Test

Read automatically, 3-15mins get the results

Large Data Capacity

Data capacity up to 50,000 results

Calibration & Quality control

- L-J QC graph, easy to identify QC results
- Multiple levels QC: QC1-QC2-QC3 ensure curate results
- Automatically calibrate: parameters directly written by reading magnetic card

Applicable Areas



Laboratory



ER



ICU



Clinics



GP Office

Test Procedure

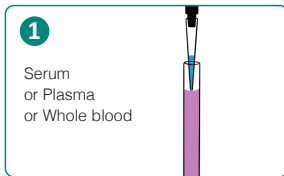

Sampling

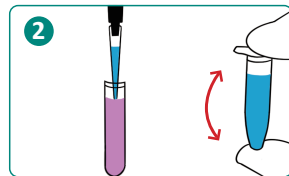

Mixing

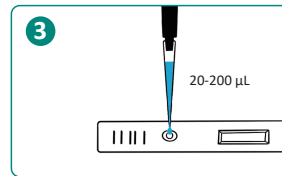

Dropping

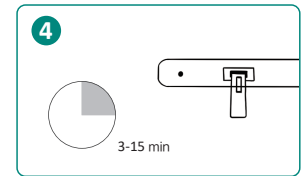

Reading

Immunia-Stat Reagent Panel

Thyroid

TSH T3 T4 FT3 FT4

Cardiac

NT-proBNP D-Dimer cTnI Myoglobin BNP CK-MB cTnI/CK-MB/Myo CTnI / NT-proBNP / D-Dimer

Inflammation

PCT IL-6 Hs-CRP SAA PCT & IL-6 Hs-CRP CRP & Hs-CRP (2 in 1) SAA & W-CRP (2 in 1)

Fertility

AMH β-HCG LH FSH Prolactin Progesterone Testosterone

Renal Panel

CYS-C NGAL MALB Cortisol

Tumor Markers

AFP CEA f-PSA T-PSA CA125 CA15-3 CA19-9

Anemia

Ferritin Folate

Specific protein

IgE

Nerve and brain injury

S100-β

Diabetes

HbA1c

Bone Metabolism

Vitamin D

Drug Abuse

MET⁺ KET⁺ MOP⁺ MDMA⁺ COC⁺ MET⁺/KET⁺/MOP⁺ THC⁺ K2⁺

Immunia-Stat

Fluorescence Immunoassay Analyzer

SPECIFICATION

Principle	Fluorescence method
Sample types	Whole blood, Serum, Plasma, etc
Sample volume	20-200 μ L, refer to reagent instruction
Consumable	Test card (including magnetic card), diluent
Light resource	LED
Wavelength	365 \pm 10nm
Scanner	Built-in bar code reader

WORK CONDITION

Ambient temperature	10°C - 30°C
Relative humidity	\leq 85%
Atmospheric pressure	70kPa-106kPa
Power supply	100-240VAC, 50/60Hz, 0.5A Max

Sicuro Bioengineering Ltd

Web	Email
http://www.sicurobio.com	info@sicurobio.com

Add
Sicuro House, 19 East West Rd, Portharcourt, Nigeria.

